

PGSB - Plastikowa przelotka kablowa

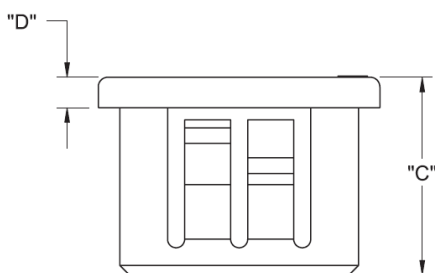
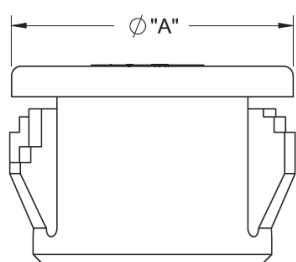
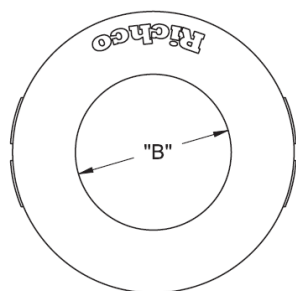

Dane techniczne:

- **Materiał:** Nylon - stabilizowany cieplnie, UL94 V2
- **Kolor:** czarny
- Łatwe zatrzaskiwanie w panelu
- Prosta instalacja, bez użycia narzędzi
- Chroni przed ostrymi krawędziami paneli

Symbol	Średnica otworu montażowego	Grubość panelu	A	B	C	D	Opakowanie
	[mm]						
PGSB-0305	4.8	1.6 - 1.7	6.5	3.2	6	1.36	1000
PGSB-1	6.35	1.57 maks.	7.9	3.2	7.9	1.6	1000
PGSB-2	7.9	1.57 maks.	9.5	4.7	7.9	1.6	1000
PGSB-3	7.9	1.57 maks.	9.5	6.1	6	1.27	1000
PGSB-4	9.5	0.8 - 3.2	11.9	4.7	10.3	1.4	1000
PGSB-5	9.5	0.8 - 3.2	11.9	6.35	10.3	1.4	1000
PGSB-0710	10	0.8 - 1.6	12	7.2	6.6	1.3	1000
PGSB-6	11.1	0.8 - 3.2	13.5	6.85	10.3	1.4	500
PGSB-7	11.1	0.8 - 3.2	13.5	7.9	10.3	1.4	500
PGSB-8	11.1	0.8 - 3.2	13.5	6.35	10.3	1.4	500
PGSB-9	11.9	1.57 maks.	13.5	8.7	6.35	1.27	500
PGSB-10	12.7	0.8 - 3.2	14.7	6.35	10.3	1.6	500
PGSB-11	12.7	0.8 - 3.2	14.7	7.9	10.3	1.6	500
PGSB-12	12.7	1.57 maks.	14.3	9.5	6.35	1.6	500
PGSB-1013	13	0.8 - 3	15	10.2	9	1.3	500
PGSB-13	13.5	1.57 maks.	15.1	10.3	6.35	1.6	500
PGSB-14	14.3	0.8 - 3.2	16.7	7.9	10.3	1.6	500
PGSB-15	14.3	0.8 - 3.2	16.7	9.9	10.3	1.6	500
PGSB-16	14.3	0.8 - 3.2	16.7	11.1	10.3	1.6	500
PGSB-17	15.9	0.8 - 3.2	18.2	6.35	10.3	1.6	500
PGSB-18	15.9	0.8 - 3.2	18.2	11.1	10.3	1.6	500
PGSB-19	15.9	1.57 maks.	17.85	12.7	6.35	1.6	500

Symbol	Średnica otworu montażowego	Grubość panelu	A	B	C	D	Opakowanie
	[mm]	[mm]	[mm]	[mm]	[mm]	[mm]	[szt./pcs]
PGSB-1316	16	1.4 - 3.5	18	12.8	10.4	1.5	500
PGSB-20	17.5	0.8 - 3.2	19.8	12.7	10.3	1.6	200
PGSB-21	17.5	0.8 - 3.2	19.8	14.3	10.3	1.6	200
PGSB-1519	19	1.3 - 3	21.7	15.3	11	1.5	200
PGSB-22	19.1	0.8 - 3.2	21.4	12.7	10.3	1.6	200
PGSB-23	19.1	0.8 - 3.2	21.4	14.3	10.3	1.6	200
PGSB-24	19.1	1.57 maks.	21	15.9	6.35	1.6	200
PGSB-25	19.8	1.57 maks.	21.8	15.9	6.35	1.6	200
PGSB-1822	22	0.9 - 2.3	24.8	18.2	11.5	1.5	500
PGSB-26	22.2	0.8 - 3.2	24.2	12.7	11.5	1.6	200
PGSB-27	22.2	0.8 - 3.2	24.2	14.3	11.5	1.6	200
PGSB-28	22.2	0.8 - 3.2	24.2	15.9	11.5	1.6	200
PGSB-29	22.2	0.8 - 3.2	24.2	17.45	11.5	1.6	200
PGSB-30	22.2	1.57 maks.	23.8	19.1	6.35	1.6	200
PGSB-31	25.4	0.8 - 3.2	28.6	19.45	11.5	1.6	200
PGSB-32	27.86	0.8 - 3.2	31	20.6	11.5	1.6	100
PGSB-33	27.86	0.8 - 3.2	31	22.2	11.5	1.6	100
PGSB-34	27.86	0.8 - 3.2	31	23.8	11.5	1.6	100
PGSB-2428	28	1 - 3.3	31.5	24	11.2	1.5	200
PGSB-2530	30	1 - 3.1	33.5	25	11.5	1.8	100
PGSB-35	31.75	0.8 - 3.2	33.3	23.8	11.5	1.6	100
PGSB-2634	34.2	1 - 3.2	38	26.2	11.5	1.5	100
PGSB-36	34.9	0.8 - 3.2	37.3	25.4	11.5	1.6	100
PGSB-37	38.1	0.8 - 3.2	40.9	27	11.5	1.6	100
PGSB-38	38.1	0.8 - 3.2	40.9	28.6	11.5	1.6	100
PGSB-39	38.1	0.8 - 3.2	40.9	33.3	11.5	1.6	100
PGSB-40	44.45	0.8 - 3.2	47.6	34.9	11.5	1.6	100
PGSB-41	50.8	0.8 - 3.2	54	41.7	11.5	1.6	100
PGSB-42	50.8	0.8 - 3.2	54	44.5	11.5	1.6	100
PGSB-43	57.2	6.35 maks.	63	47	18.2	1.6	100
PGSB-O-903	4.7	1.6 maks.	6.4	3.2	5.9	1.6	1000
PGSB-O-492	6.6	1.6 maks.	8	3.2	8	1.6	1000
PGSB-O-905	7.1	1.6 maks.	8.7	5.5	5.9	1.6	1000
PGSB-O-907	8.7	1.6 maks.	10.3	5.5	6.4	1.6	1000
PGSB-O-908	9.5	1.6 maks.	11.1	6.3	6.4	1.6	1000
PGSB-O-494	9.5	3.2 maks.	11.9	4.8	10.3	1.6	1000
PGSB-O-909	10.3	1.6 maks.	11.9	7.1	6.4	1.6	1000
PGSB-O-910	11.1	1.6 maks.	12.7	7.9	6.4	1.6	1000
PGSB-O-499	12.7	3.2 maks.	14.7	6.4	10.3	1.6	1000
PGSB-O-500	12.7	3.2 maks.	14.7	8	10.3	1.6	1000
PGSB-O-501	12.7	3.2 maks.	14.7	9.5	10.3	1.6	1000
PGSB-O-893	12.7	6.4 maks.	14.7	9.9	14.3	1.6	1000
PGSB-O-504	14.3	3.2 maks.	16.7	11	10.3	1.6	1000
PGSB-O-507	15.9	3.2 maks.	18.2	12.7	10.3	1.6	1000
PGSB-O-513	19	3.2 maks.	21.4	16	10.3	1.6	1000
PGSB-O-514	20.6	3.2 maks.	22.6	14.3	10.3	1.6	1000
PGSB-O-515	20.6	3.2 maks.	22.6	16	10.3	1.6	1000
PGSB-O-894	22.2	6.4 maks.	24.2	17.5	14.3	1.6	1000
PGSB-O-919	25.4	1.6 maks.	27	22.3	6.4	1.6	1000
PGSB-O-522	25.4	3.2 maks.	28.6	19	11.5	1.6	1000
PGSB-O-895	25.4	6.4 maks.	28.6	19.4	14.3	1.6	1000
PGSB-O-896	28.6	6.4 maks.	30.9	23.8	14.3	1.6	1000
PGSB-O-898	31.8	6.4 maks.	33.2	25.4	14.3	1.6	1000
PGSB-O-526	30.2	3.2 maks.	33.3	24	11.5	1.6	1000
PGSB-O-897	30.2	6.4 maks.	33.3	23.8	14.3	1.6	1000

Symbol	Średnica otworu montażowego	Grubość panelu	A	B	C	D	Opakowanie
	[mm]	[mm]	[mm]	[mm]	[mm]	[mm]	[szt./pcs]
PGSB-O-899	34.9	6.4 maks.	38.1	25.4	14.3	1.6	1000
PGSB-O-900	38.1	6.4 maks.	41.2	33.3	14.3	1.6	500
PGSB-O-901	44.5	6.4 maks.	47.6	34.9	14.3	1.6	500
PGSB-O-902	50.8	6.4 maks.	54	41.3	14.3	1.6	500
PGSB-O-884	53.1	6.4 maks.	59.7	46	18.3	1.6	500
PGSB-O-886	63.5	6.4 maks.	67.5	51	18.1	1.6	500
PGSB-O-887	76.2	6.4 maks.	80.2	61.9	18.1	1.6	500
PGSB-O-888	85.7	6.4 maks.	92.9	71.4	18.3	1.6	500
PGSB-O-889	88.9	6.4 maks.	92.8	74.6	18.1	1.6	250
PGSB-O-890	101.6	6.4 maks.	105.6	87.3	18.1	1.6	250