

## O-SLINS - Steel-Based Tiltserts

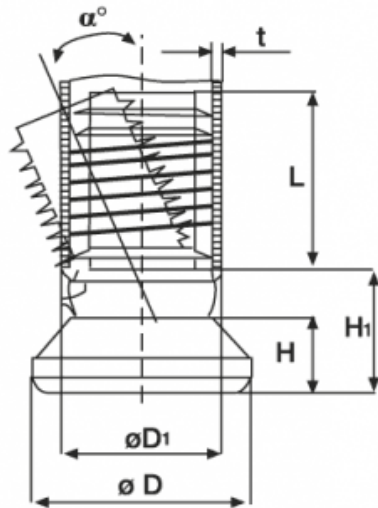

**Details:**

- **Material:** Nylon
- **Color:** black
- **Articulating glide with steel base ideal for carpeted floors**

Symbol	Angle $\alpha$	Ext. diameter $\varnothing D$	$\varnothing D_1$	H	$H_1$	L	t	Material	Color
	[°]	[mm]	[mm]	[mm]	[mm]	[mm]	[mm]		
O-SLINS-30-28	19	30	28	10	17	24.5	1.5 - 2.0	PA	black