

**BL-POK500 - Star handwheels**

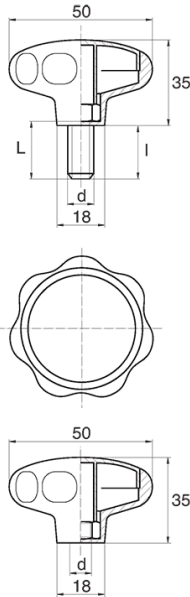

Details:

- **Handle material: Nylon**
- **Handle colour: black**; other colours available on special order
- Thread material: see table; For type M stainless steel, brass and aluminium available on special order
- Type:
  - F - female
  - M - male
- Standard pack: 100 pcs

| Symbol          | Type | Ext. thread<br>d | Int. thread<br>d | Thread material | L    | l ±1mm | Material | Color |
|-----------------|------|------------------|------------------|-----------------|------|--------|----------|-------|
|                 |      |                  |                  |                 | [mm] | [mm]   |          |       |
| BL-POK500F-M6-4 | F    | -                | M6               | PA              | -    | -      | PA       | black |