

BL-WRP - Rectangular tube inserts

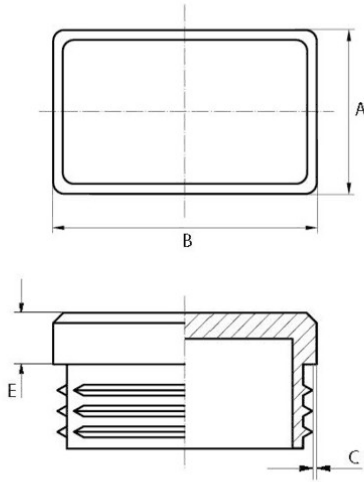

Details:

- **Material: PE**
- **Colour: black**
- White, grey (RAL 7042) and other colours available on special order
- Other materials available on special order
- Depending on the mould, the surface of the part can be smooth or dull

| Symbol | A x B | C wall thickness | E | Opakowanie |
|--------------------|---------|------------------------|-----|------------|
| | [mm] | | | [szt.] |
| BL-WRP-40-70-10-30 | 40 x 70 | 1.0 - 3.0 | 5.0 | 100 |